



NOTES:

Rated Current:1.0AMP.
 Contact Resistance:20mΩ Max.
 Withstand Voltage:500V AC/DC
 Insulation Resistance:1000MΩ Min.
 Operation Temperature:-40℃ to +105℃

Contact Material:Brass
 Contact Plating:Au or Sn Over Ni
 Insulator Material:PA9T+30%G.F UL94V-0 BK

Recommended P.C.B Layout (Top Side)
 (PCB BOARD TOLERANCE±0.05)

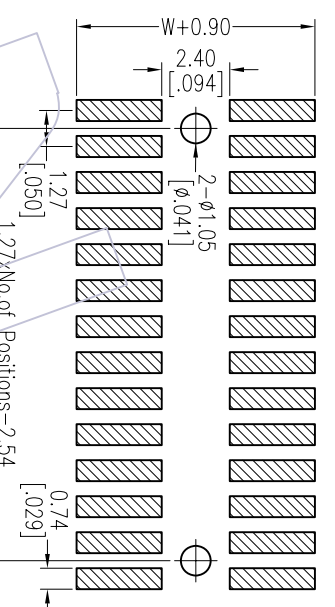
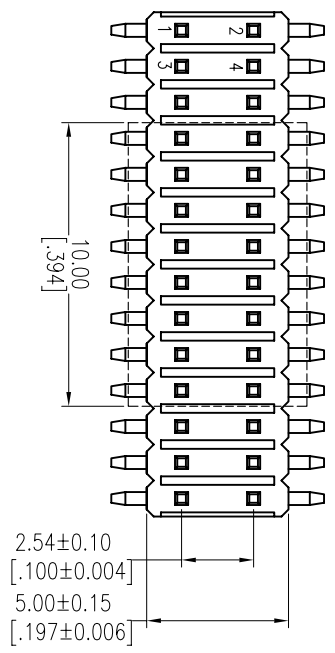

Ordering Information

1425-12 XX XX M XXX X X

No. of Pins Contact Plating Pin Length Series No.
 Per Row:02-50 G=Gold Flash L=B+D-2.5; W₂±.44 1=1 type 1
 G3=10u"Gold Standard;D79=7.9 2=1 type 2
 G4=15u"Gold 111=11.1
 G5=30u"Gold
 S0=Gold Flash/Tin
 S3=10u"Gold/Tin
 S4=15u"Gold/Tin
 S5=30u"Gold/Tin

Packing
 T=Tube
 P=Tube+CAP
 R=Tube&Reel+CAP

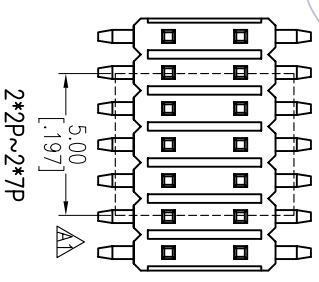
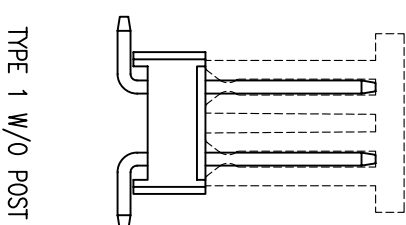
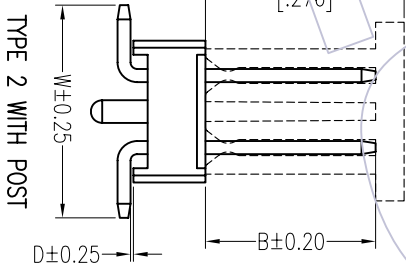
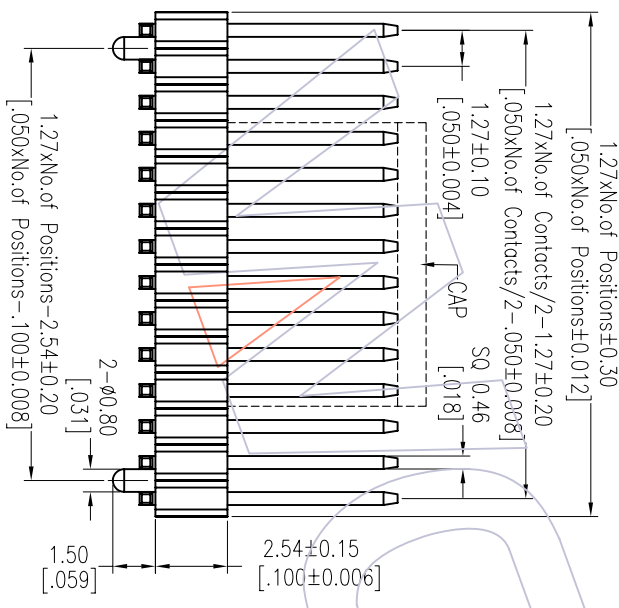

| Item | Pin Length | W | D | B | Molding |
|-----------|------------|------|------|------|---------|
| Standard | 7.90 | 7.50 | 0.10 | 2.80 | 2446 |
| Alternate | 11.10 | 7.50 | 0.10 | 6.00 | 2485 |

| REV | DATE | MODIFICATION DESCRIPTION | CHANGE | OPERATION | DRAW | DATE | SCALE | PART NO. | TITLE: | WCON-Dongguan | WCON-Kunshan |
|-----|------------|--------------------------|--------|------------|--------------|------------|-------|-------------------|---------------------------------|------------------------|------------------------|
| A1 | 2012/09/20 | Modify Drawing | --- | XXX ±0.40 | William Diao | 2012.09.20 | mm | 1425-12XXXXMXXXXX | PH1.27*2.54 DUAL ROW SMT H=2.54 | Tel: +86 769 85358920 | Tel: +86 512 57468408 |
| A0 | 2012/04/06 | NEW | --- | XXX ±0.15 | CHECK | --- | A4 | --- | --- | Fax: +86 769 85358915 | Fax: +86 512 57468468 |
| REV | DATE | MODIFICATION DESCRIPTION | CHANGE | Angle ± 3° | APPROVE | DATE | 1/1 | Customer NO. | --- | E-mail: sales@wcon.com | E-mail: sales@wcon.com |



Http: www.wcon.com

WCON-Dongguan
 Tel: +86 769 85358920
 Fax: +86 769 85358915
 E-mail: sales@wcon.com

WCON-Kunshan
 Tel: +86 512 57468408
 Fax: +86 512 57468468
 E-mail: sales@wcon.com