

# HSF

**NOTES:**

- Rated Current: 12.0 AMP
- Contact Resistance: 20 mΩ Max
- Withstand Voltage: 2000 V AC/DC
- Insulation Resistance: 1000 MΩ min
- Operation Temperature: -40°C to +105°C
- No. of Positions: 2~24
- Terminal Material: Brass
- Terminal Plating: Matte Tin Plated Over Nickel
- Housing Material: PA66+30%GF(Ul94V-0) 

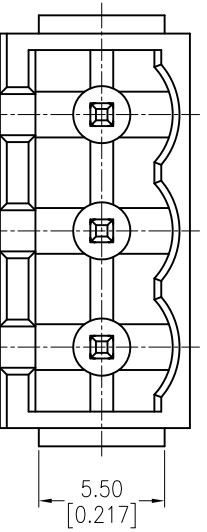

5.08XNo. of Positions-5.08±0.40  
[0.200XNo. of Positions-0.200±0.016]

5.08XNo. of Positions+3.60±0.40  
[0.200XNo. of Positions+0.142±0.016]

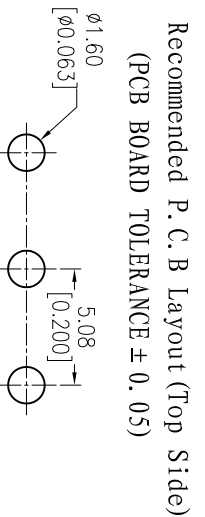

7.70  
[0.303]

5.08XNo. of Positions+2.0±0.40  
[0.200XNo. of Positions+0.079±0.016]

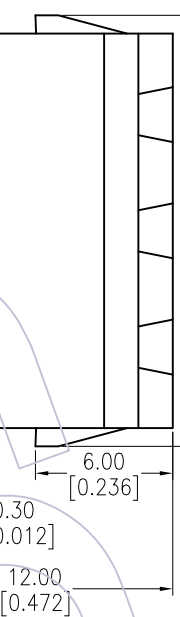

3.90±0.30  
[0.154±0.012]

SQ 1.00  
[0.039]

3.85  
[0.152]

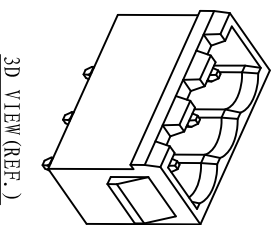
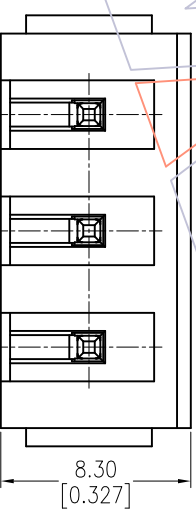

**Ordering Information:**

P M 508 - 1 S XX A SM 4 N

M=Male Pitch 508=508  
No. of Pins 02=24P Color Contact Plated Series No. A=Green SM=Matte Tin

OPERATION	DRAW	DATE	SCALE	FIT	PART NO.	<b>WCON</b> Http: www.wcon.com WCON-Dongguan Tel: +86 769 85358920 Fax: +86 769 85358915 E-mail: sdes@wcon.com
X.X	Tsingna	2013/06/05	mm	1/1	PMS08-1SXXASM4N	
CHECK	CHECK	DATE	UNIT	SIZE	TITLE:	WCON-Kunshan Tel: +86 512 57468408 Fax: +86 512 57468468 E-mail: sdesks@wcon.com
X.XXX	X.XXX	DATE	inch	A4	5.08mm Pitch Male Pluggable Terminal Blocks (With Polarization)	
ANGLE	APPROVE	DATE	SHEET	PROJ.	Customer NO.	
± 3'			1/1			
DIM TOL	CHANGE					
REV	DATE	MODIFICATION DESCRIPTION				
A1	2013/06/05	Modify The Housing Material				
A0	2012/09/13	NEW				

1 2 3 4 5 6 7 8 9 10

H G F E D C B A